



**SPECIAL EVENT PERMIT**

**2015-11**

All fees have been paid in full as required by this permit. This special event permit shall expire and be null and void at the conclusion of the event, if any conditions herein are breached, or if the permit is transferred to any other person, corporation, organization, or entity.

**EVENT INFORMATION**

Event Name: **Cow A Bunga Race**

Event Date(s): **16 May 2015**

Applicant: Jeff Young

Event Type: Race

Phone: 435-232-8056

Promoting Entity: Richmond City Corporation

Email: jeffyoung.y@gmail.com

15 MAY 2015

Approved by: Director of Development Services

Date

**CONDITIONS OF APPROVAL**

1. All participants and volunteers shall comply with County Ordinance §8.40 governing special events.
2. As necessary, event organizers, staff, participants, and spectators must allow access for emergency vehicles in the case of a wildland fire.

**AGREEMENT OF ACCEPTANCE**

As the applicant for the special event described above, I hereby agree to comply with all Federal, State, and County laws, ordinances, and regulations before, during and after the event. I further agree to indemnify and save harmless Cache County, its officers, agents, and employees from and against any and all claims resulting from the use of the premises by the Applicant, the Applicant's invitees, licensees, agents and employees. I agree to permit law enforcement personnel the free and unrestricted access to and upon the premises at all times during the event for all lawful and proper purposes not inconsistent with the intent of the permit.

I understand and agree that this permit may be revoked upon breach of any of the conditions herein or at the discretion of the authorized officer. I understand that this permit is not transferable and agree not to transfer my permit to any person, corporation, organization or other entity, and is only valid within the unincorporated county.

In Accordance with Title 8 Section 8.40 of the Cache County Ordinance, I hereby submit and certify that the above information provided is accurate and complete to the best of my knowledge.

Accepted by: Applicant

5/15/15  
Date



**Cache County**  
1857

**DEVELOPMENT SERVICES DEPARTMENT**

BUILDING | COUNTYWIDE PLANNING | ENGINEERING | GIS | PLANNING & ZONING

**SPECIAL EVENT APPLICATION**

Date Received:	By:	Receipt #:	Amount:	Check #:
5-1-15	SN	8034	50.00	23619

PROMOTING ENTITY INFORMATION	APPLICANT INFORMATION
NAME OF PROMOTING ENTITY: <u>RICHMOND CITY CORPORATION</u> CONTACT PERSON: <u>JEFF YOUNG</u> ADDRESS: <u>PO BOX 9</u> <u>RICHMOND UT 84333</u> PHONE (DAY) _____ (CELL) <u>435-232-8076</u> EMAIL: <u>JEFF.YOUNG.Y@GMAIL.COM</u>	APPLICANT NAME: <u>SAME</u> MAILING ADDRESS: <u>SAME</u> PHONE (DAY) _____ (CELL) _____ EMAIL: _____
EVENT INFORMATION	
EVENT NAME: <u>COUD-A-BUNGA RACE</u> EVENT TYPE: <u>FUN RUN - 1 MILE, 5K, 12K</u> EVENT DATES: <u>5-16-15</u> BEGINING TIME FOR EACH DATE: _____ ENDING TIME FOR EACH DATE: _____	

**General Recitals:**

Completed application forms shall be submitted to the Cache County Development Services Office forty-five (45) calendar days before the event is scheduled to take place, in order to allow sufficient time for final evaluation of the application. Applications submitted less than forty-five calendar days prior to the scheduled event shall be denied unless the applicant demonstrates that compliance with the forty-five day deadline was impractical or impossible due to the nature of the event.

A special event permit application may be approved and a permit issued to the applicant by the Administrator upon approval by all the agencies specified in Section 8.40.40.

Cache County has no authority to approve or permit events other than in the unincorporated area of Cache County. Permits issued by Cache County apply only to the unincorporated area of the county, and if an event crosses into a municipality within Cache County or across the county line, applicants should determine if a permit is necessary in the other jurisdiction.

Cache County reserves the right to deny permit applications for proposed special events which may pose, or have in the past posed, a significant danger or threat to the public health, welfare or safety, or which may result in unreasonable inconvenience or cost to the public. In the event the application is denied the applicant may appeal to the Cache County Executive.

In accordance with Title 8 Section 8.40 of the Cache County Ordinances adopted on June 29, 2010, I hereby submit and certify that the information contained in this application is accurate and complete to the best of my knowledge.

Signed Jeff Young Applicant 4-9-15 Date

DEVELOPMENT SERVICES DEPARTMENT  
179 NORTH MAIN, SUITE 305  
LOGAN, UTAH 84321

PHONE: (435) 755-1640 FAX: (435) 755-1987  
EMAIL: devservices@cachecounty.org  
WEB: www.cachecounty.org/devserv

**APPLICATION CHECKLIST**  
**ALL ITEMS REQUIRED UNLESS SPECIFIED OTHERWISE**

1. Completed application form.
2. Non-refundable application fee (\$50).
3. List of all sponsors with contact information for each.
4. Proposed location, including a plat or map of the proposed area to be used, including any barricade, street route plans or perimeter/security fencing.
5. Estimated numbers of event staff, participants and spectators.
6. Public health plans, including plans for culinary water supplies, solid waste collections and disposal and waste water (toilet facilities).
7. Proof of insurance in conformance with County Ordinance 8.40.050(F).  
 (\$1,000,000 one person, \$2,000,000 two or more persons, \$100,000 property damage)
8. Fire prevention and emergency medical services plans.
9. Security plans and/or law enforcement response.
10. Admission fee, donation, or other consideration to be charged or requested.
11. Plans for Parking
12. *If* the event will be held on private property, a current taxation certification for that property.
13. Further information may be required by staff, other departments and agencies, and/or the Board/Committee/Council that reviews the application based on the proposed event.

**PROJECT REVIEW PROCESS:**

- The applicant should meet with staff prior to the deadline date to discuss the project and ensure that the information submitted is sufficient to completely review the project.
- After the application is accepted, information packets are sent to various departments, agencies, and affected municipalities that provide comments and/or approval for the event to the Director of Development Services.
- A pre-development meeting is held with planning staff and representatives from the departments and agencies that provide comments on the project review. Any issues present on a project will be discussed with the appropriate department or agency.
- A draft permit is made available to the reviewing agencies, affected municipalities, staff, and the applicant.
- Following agency/department review and approval, payment of all necessary fees, and correction of any outstanding concerns/issues, the permit can be issued.

FEE SCHEDULE	
Base Application Fee (non-refundable)	\$50.00
Other Fees if necessary	Sheriff, Health Dept., Emergency Services, Other

**COMPLIANCE INFORMATION  
RICHMOND CITY SPECIAL EVENT  
COWABUNGA RACE - 1 MILE, 5 KILOMETER, 12 KILOMETER  
SATURDAY, MAY 16, 2015 STARTING AT 8:00 A.M.**

**3. SPONSORS:**

CHERRY PEAK RESORT - John Chadwick 435-625-1822

CASPERS ICE CREAM - BIG BOY - Jeff Young 435-232-8056

4. Attached

5. PARTICIPATION: ESTIMATE 100 STAFF, PARTICIPANTS, AND SPECTATORS (As of May 1<sup>st</sup>, only twelve have signed up.)

6. EXISTING PUBLIC HEALTH FACILITIES ARE ADEQUATE.

7. Attached.

8. EMT'S AND FIRE PERSONNEL ARE ON ALERT FOR THE ENTIRE BLACK & WHITE DAYS PERIOD - MAY 12<sup>TH</sup> THROUGH 16<sup>TH</sup>. NO SPECIAL NOTIFICATION IN REQUIRED.

9. NO ADDITIONAL LAW ENFORCEMENT SERVICES ARE REQUIRED FOR THIS EVENT.

10. FEE IS \$7.00 PER RUNNER OR \$30.00 FOR A FAMILY

# CERTIFICATE OF INSURANCE

Issue Date  
  
5/1/15

**Producer**  
*Utah Local Governments Trust*  
55 South Highway 89  
North Salt Lake UT 84054

THIS CERTIFICATE IS ISSUED AS A MATTER OF INFORMATION ONLY AND CONFERS NO RIGHTS UPON THE CERTIFICATE HOLDER. THIS CERTIFICATE DOES NOT AMEND, EXTEND OR ALTER THE COVERAGE AFFORDED BY THE POLICIES BELOW.

**Insured**  
*Richmond City*  
6 West Main Street  
Richmond UT 84333

COMPANIES AFFORDING COVERAGE	
<b>Company A</b>	<i>Utah Local Governments Trust</i>
<b>Company B</b>	
<b>Company C</b>	
<b>Company D</b>	

**COVERAGES**

THIS IS TO CERTIFY THAT THE POLICIES OF INSURANCE LISTED BELOW HAVE BEEN ISSUED TO THE INSURED NAMED ABOVE FOR THE POLICY PERIOD INDICATED, NOTWITHSTANDING ANY REQUIREMENT, TERM OR CONDITION OF ANY CONTRACT OR OTHER DOCUMENT WITH RESPECT TO WHICH THIS CERTIFICATE MAY BE ISSUED OR MAY PERTAIN, THE INSURANCE AFFORDED BY THE POLICIES DESCRIBED HEREIN IS SUBJECT TO ALL THE EXCLUSIONS AND CONDITIONS OF SUCH POLICIES, LIMITS SHOWN MAY HAVE BEEN REDUCED BY PAID CLAIMS.

CO.	TYPE OF INSURANCE	POLICY NUMBER	POLICY EFFECTIVE	POLICY EXPIRATION	ALL LIMITS
A	General Liability Claims Made Occurrence <input checked="" type="checkbox"/>	13180-GL2014	7/1/14	7/1/15	General Aggregate <span style="float: right;">\$5,000,000</span>
A	Auto Liability Any Auto <input checked="" type="checkbox"/> All Owned Autos Scheduled Autos	13180-GL2014	7/1/14	7/1/15	Combined Single Limit <span style="float: right;">\$5,000,000</span> Bodily Injury per Person Bodily Injury per Accident Property Damage
	Workers' Compensation and Employers' Liability				Statutory As Per Utah Law
	Auto Physical Damage				Deductible Comprehensive Collision
A	Property	ULGT-APDP-2010	7/1/14	7/1/15	Deductible <span style="float: right;">\$1,000.00</span> Coverage <span style="float: right;">SPECIAL FORM</span>
	Other				

**DESCRIPTION**

Confirmation of General/Auto Liability Coverage and Property Coverage for Richmond Town in regards to the Black and White Days May 2015.

**CERTIFICATE HOLDER**

*Cache County*  
179 N Main  
Logan UT 84321

**CANCELLATION**

SHOULD ANY OF THE ABOVE DESCRIBED POLICIES BE CANCELLED BEFORE THE EXPIRATION DATE THEREOF, THE ISSUING COMPANY WILL ENDEAVOR TO MAIL 10 DAYS WRITTEN NOTICE TO THE CERTIFICATE HOLDER NAMED TO THE LEFT, BUT FAILURE TO MAIL SUCH NOTICE SHALL IMPOSE NO OBLIGATION OR LIABILITY OF ANY KIND UPON THE COMPANY, ITS AGENTS OR REPRESENTATIVES.

**AUTHORIZED REPRESENTATIVE**

  
Steven A Hansen, CEO



A Google Maps feature used on this page is ch

To see all the details that are visible on the screen, use the "Print" link next to the map.

migrated. [Learn more](#) [Dismiss](#)

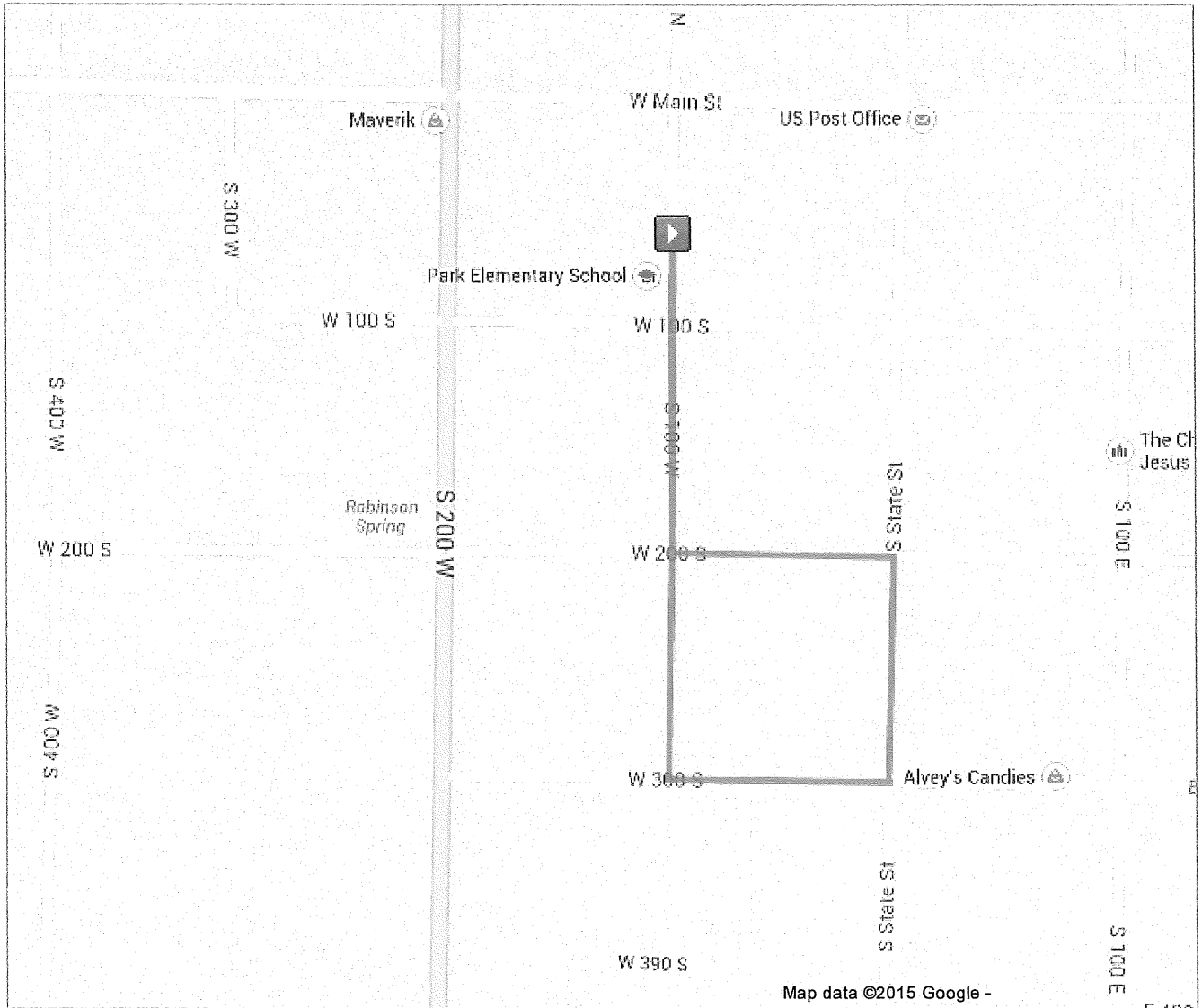

Displaying content from www.mapmyfitness.com

The content displayed below and overlaid onto this map is provided by a third party, and Google is not responsible for it. Information you enter below may become available to the third party.

Contents

-  Cowabunga Mile
- Cowabunga Mile

# COWABUNGA RACE - 1 MILE



A Google Maps feature used on this page is ch

To see all the details that are visible on the screen, use the "Print" link next to the map.

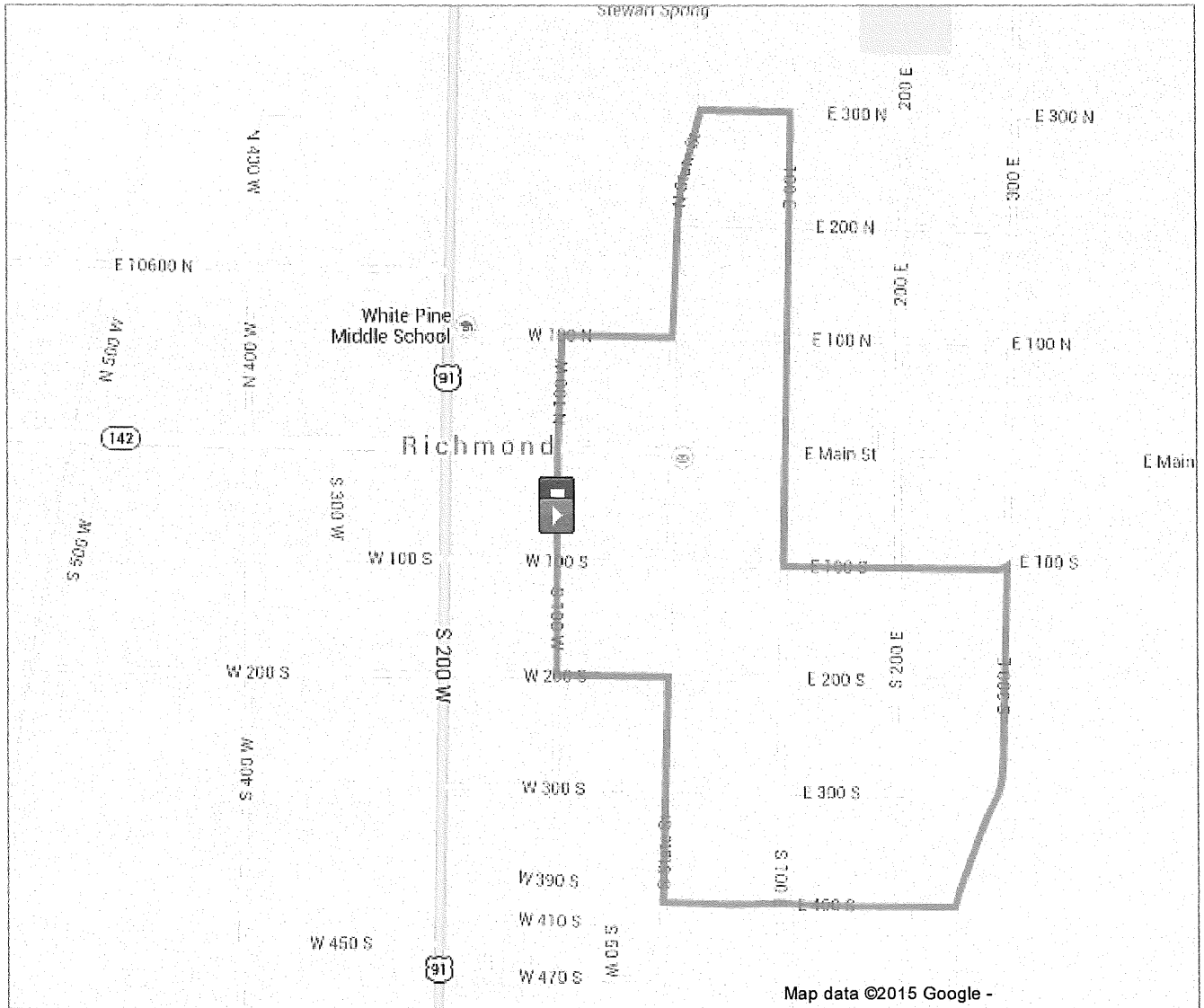

migrated. [Learn more](#) [Dismiss](#)



Displaying content from www.mapmyfitness.com

The content displayed below and overlaid onto this map is provided by a third party, and Google is not responsible for it. Information you enter below may become available to the third party.

**Contents**

-  Cowabunga Ideal!!
-  Cowabunga Ideal!!
- Cowabunga Ideal!!

**COWABUNGA RACE - 5 KILOMETER**



A Google Maps feature used on this page is ch

To see all the details that are visible on the screen, use the "Print" link next to the map.

migrated. [Learn more](#) [Dismiss](#)

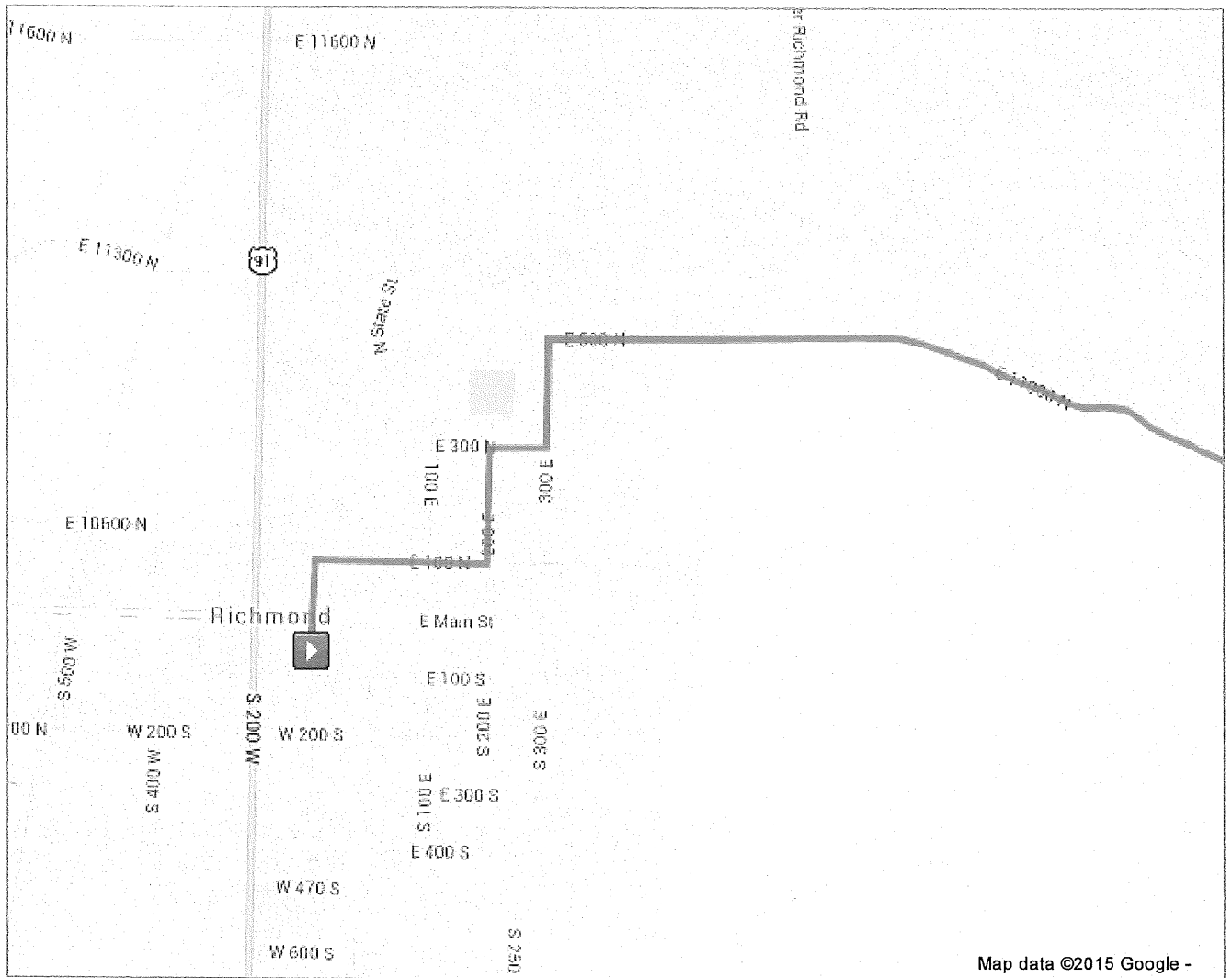

Displaying content from www.mapmyfitness.com

The content displayed below and overlaid onto this map is provided by a third party, and Google is not responsible for it. Information you enter below may become available to the third party.

Contents

-  Cherry Peak Race (12K=7.46 Mi)
- Cherry Peak Race (12K=7.46 Mi)

## COWABUNGA RACE - 12 KILOMETER